

FEATURES

Reference Standards	BS7626 1993, BS3938, CENELEC HD 533 S2 1993, IEC185, VDE 0414, CEI 38-1, UTE NF 42-502
Housing	Self extinguishing thermoplastic classification VO to UL94
Insulation	Class E
Temperature Range	Working -25 to +50°C, relative humidity 85% Max conductor temperature 70°C Storage -40 to +80°C
Frequency	50/60Hz (higher frequency on request)
System Voltage	720V max.
Test Voltage	3KV for 1 minute
Thermal short circuit current (I _{th})	Limited by conductor size, except wound primary models 60 In
Dynamic short circuit current (I _{dyn})	2.5 I _{th}
Saturation Co-efficient	<5
Terminal Markings	Primary P1 & P2 (K & L) Secondary S1 & S2 (k & l)

APPLICATION NOTE

When using CT's with an aperture, it is possible to reduce primary ratio by passing multiple turns of the primary conductor cable through the aperture. The resultant ratio will be CT primary divided by the number of turns, e.g. a 200/5A CT with the primary conductor passed through the aperture twice will produce a CT ratio of 100/5A.

SECONDARY LEAD BURDEN

When selecting a current transformer, it is important to consider the power absorbed by the cables connected between the CT secondary terminals and the measuring instrument. The resultant cable burden should be added to the equipment burden, and the total should not exceed the available VA of the CT. Where the current transformer is to be mounted remotely, a -/1A secondary is recommended. For every 10°C variation in temperature, the VA absorbed by the cables will increase by 4% (Ambient Reference Temp °C)

OPTIONS

Tropicalized execution	Working temperature -25 to +60°C, relative humidity >95% Max conductor temperature 90°C
Storage temperature	-40 to +80°C
H ₂ S execution	Max. concentration 8ppm
System Voltage	1.2KV
Test Voltage	6KV for 1 minute

SPECIAL VERSIONS

* Medium Voltage CT's (system voltage up to 24KV) * Three Phase CT's * Ratio Calibration CT's * Split Core CT's (for temporary or permanent installation) * Saturation CT's * Heavy Starting CT's * Signal Generator CT's * Overload CT's

IMPORTANT NOTE

1. It is essential with certain instrumentation that the CT is physically positioned correctly on the conductor. P1 (K) must face the supply feeder, and P2 (L) must face the load. It is also important to ensure that secondary connections are made in accordance with instrument diagrams.
2. The secondary terminals of the CT must NOT be open-circuited on load as dangerously high voltages may be present under these conditions. It is recommended that one side of the secondary windings is earthed.

VA Burden for 5A C.T.s.

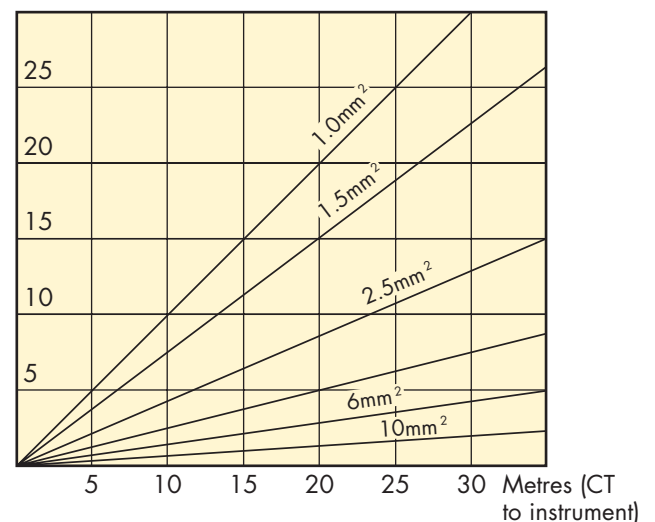

VA Burden for 1A C.T.s.

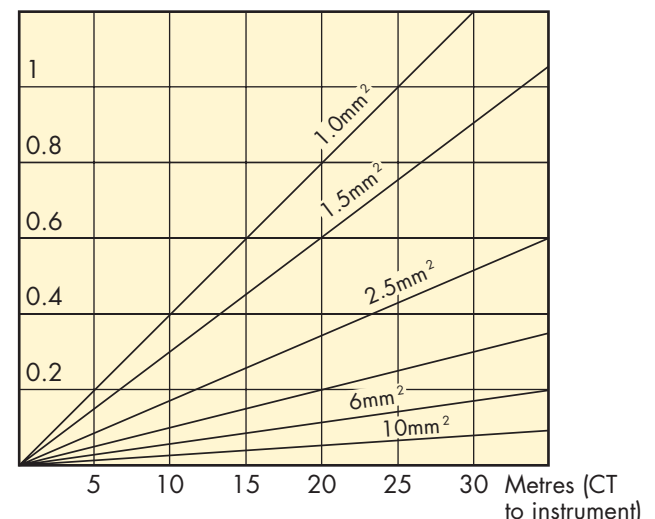

Integra Range - Moulded Case

TAI200, TAI210, TAI230, TAI233

DESCRIPTION

A range of current transformers with general features as described on page 48 of this catalogue. All units in this range offer moulded fixings for foot, DIN rail, or busbar mounting, along with integral moulded terminal covers. Secondary connection may be made by fast-on connector or screw terminals. Models TAI 312 and TAI402 offer class 0.2 accuracy.

TAI200

Cable Aperture 22mm dia
Busbar Window 20x5mm
Secondary Terminals M4 screws/
 6.3x0.8mm fast-on
Weight 270g

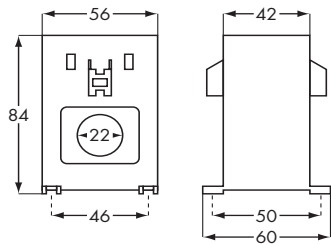

Primary current A	Burden		
	cl. 0-5 VA	cl. 1 VA	cl. 3 VA
50	-	-	2
60	-	-	2.5
70	-	-	3
75	-	-	3
80	-	-	3
100	-	2	4
120	-	3	5
125	-	3	5
150	2	4	6
200	3	6	8
250	5	8	10

1A or 5A secondary

TAI210

Cable Aperture 17mm dia
Busbar Window 20x5mm
Secondary Terminals M4 screws/
 6.3x0.8mm fast-on
Weight 220g

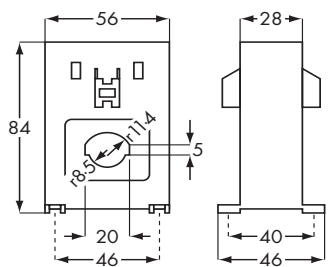

Primary current A	Burden		
	cl. 0-5 VA	cl. 1 VA	cl. 3 VA
50	-	-	1.5
60	-	-	1.5
70	-	-	3
75	-	-	2
80	-	-	2
100	-	1.5	2.5
120	-	2	3
125	-	2	3
150	-	2.5	4
200	2	4	6

1A or 5A secondary

TAI230

Cable Aperture 23mm
Busbar Window 30x10mm,
 25x12mm
 20x11mm
Secondary Terminals M4 screws/
 6.3x0.8mm fast-on
Weight 270g

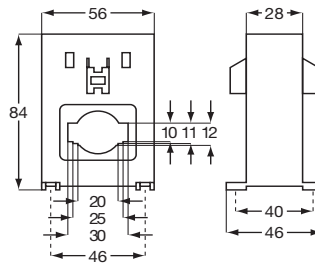

Primary current A	Burden		
	cl. 0-5 VA	cl. 1 VA	cl. 3 VA
150	-	-	1.5
200	-	2	3
250	-	2	3
300	2	3	4
400	3	4	5
500	4	5	6
600	5	6	8

1A or 5A secondary

TAI233

Cable Aperture 23mm
Busbar Window 30x10mm,
 25x12mm
 20x11mm
Secondary Terminals M4 screws/
 6.3x0.8mm fast-on
Weight 270g

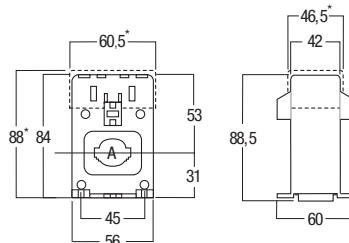
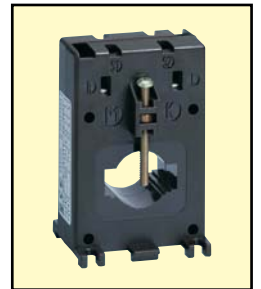

Primary current A	Burden		
	cl. 0-5 VA	cl. 1 VA	cl. 3 VA
40	-	-	1.5
50-60	-	-	2.5
70	-	-	3
75	-	1.25	3.5
80	-	1.5	4
100	-	2.5	5
120	-	3.5	5.5
125	1	4	5.5
150	1.5	5.5	6.5
200	4	7	8.5
250	6	9	11
300	7.5	11	13.5
400	10.5	15	18
500	12	18	22
600	14.5	21.5	26

1A or 5A secondary

Integra Range - Moulded Case

TAI300 /310 /312 /400 /402 /500

TAI300

Cable Aperture 22mm dia
Busbar Window 31x11mm,
 21x14mm
Secondary Terminals M4 screws/
 6.3x0.8mm fast-on
Weight 290g

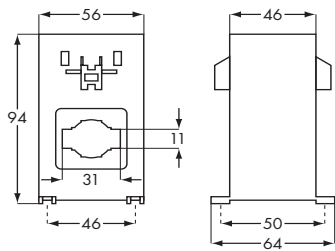

Primary current A	Burden		
	cl. 0-5 VA	cl. 1 VA	cl. 3 VA
100	-	2	3
120	-	2.5	3.5
125	-	2.5	3.5
150	-	3.5	4.5
200	3	4	6
250	5	6	8
300	6	8	9
400	7.5	10	12
500	10	12	15
600	12	15	15

1A or 5A secondary

TAI400/TAI402

Cable Aperture 35mm dia
Busbar Window 40x10.5mm
Secondary Terminals M4 screws/
 6.3x0.8mm fast-on
Weight 400g

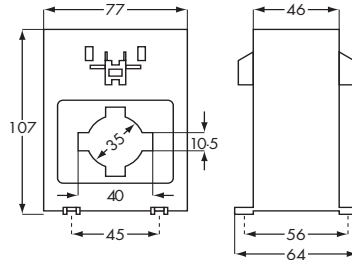

Primary current A	Burden			
	TAI400			TAI402
	cl.0-5 VA	cl.1 VA	cl.3 VA	cl.0-2 VA
50	-	-	1.5	-
60	-	-	2	-
70	-	-	3	-
75	-	-	3	-
80	-	-	3	-
100	-	1	4	-
120	-	2	5	-
125	-	2	6	-
150	1	3	6	-
200	1.5	3	6	1.5
250	2.5	5	8	2.5
300	4	8	12	2.5
400	8	12	15	4
500	10	12	15	6
600	10	12	15	8
700	10	12	15	-
750	10	12	15	8
800	10	12	15	8
1000	10	12	15	10

1A or 5A secondary

TAI310/TA312

Cable Aperture 28mm dia
Busbar Window 31x11mm
Secondary Terminals M4 screws/
 6.3x0.8mm fast-on
Weight 370g

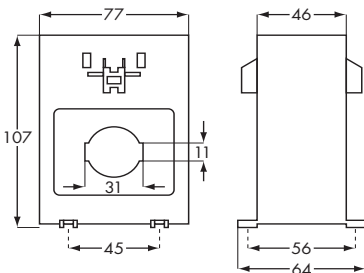

Primary current A	Burden			
	TAI310		TAI312	
	cl.0-5 VA	cl.1 VA	cl.3 VA	cl.0-2 VA
50	-	-	2	-
60	-	-	3	-
75	-	-	3.5	-
80	-	1.5	3.5	-
100	-	2	6	-
120	1	2	8	-
125	1	2	8	-
150	1.5	3.5	10	-
200	4	8	12	1.5
250	6	12	15	2.5
300	10	15	20	5
400	15	20	25	8
500	20	25	30	10
600	25	25	30	15

1A or 5A secondary

TAI500

Busbar Window 51x12.5mm
Secondary Terminals M4 screws/
 6.3x0.8mm fast-on
Weight 400g

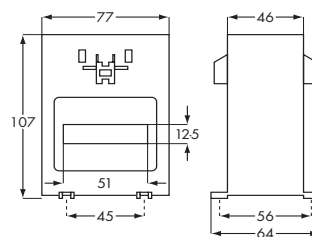

Primary current A	Burden		
	cl. 0-5 VA	cl. 1 VA	cl. 3 VA
250	-	-	3
300	-	2	4
400	-	4	6
500	2	4	6
600	6	8	10
800	8	10	12
1000	10	12	15
1200	12	15	20

1A or 5A secondary

Moulded Case

TAIBB, TAS20B, TAS21, TAS23

TAIBB

Cable aperture 21mm dia
 Secondary Terminals M4 screws
 Weight 180g

Supplied with fixing feet, hinged terminal covers and DIN rail adaptor.

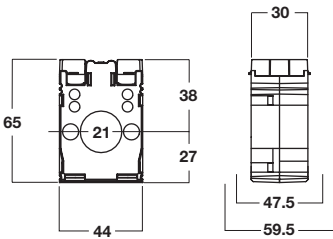

Primary current A	Burden		
	cl. 0-5 VA	cl. 1 VA	cl. 3 VA
40	-	-	1
50	-	1.25	1.5
60	-	1.25	2
70	-	1.5	2.5
75	-	1.5	2.5
80	-	1.5	2.5
100	2	2.5	3.5
120	2.5	3.5	4
125	2.5	3.5	4
150	3	4	5
160	3	4	5
200	4	5.5	6
250	5	6	7
300	6	7.5	8

5A secondary

TAS21

Cable aperture 17mm dia
 Busbar window 20x5mm
 Secondary Terminals M4 screws/fast-on connectors
 Weight 200g

Supplied with fixing feet and busbar mounting bracket.

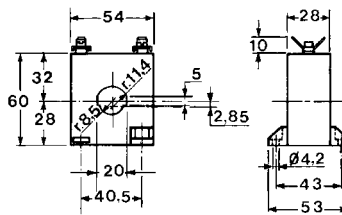

Primary current A	Burden		
	cl. 0-5 VA	cl. 1 VA	cl. 3 VA
50	-	-	1.5
60	-	-	1.5
80	-	-	2
100	-	1.5	2.5
120	-	2	3
150	-	2.5	4
200	2	4	6

1A or 5A secondary

Option: DIN rail adaptor
 Terminal cover

TAS20B

Cable aperture 22mm dia
 Busbar window 20x5mm
 Secondary Terminals M4 screws/fast-on connectors
 Weight 250g

Supplied with fixing feet, busbar mounting bracket and built-in 35mm DIN rail clip.

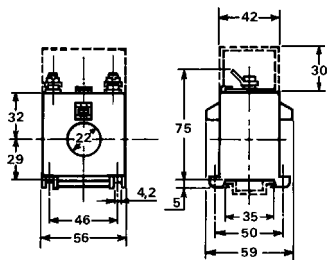

Primary current A	Burden		
	cl. 0-5 VA	cl. 1 VA	cl. 3 VA
50	-	-	2
60	-	-	2.5
80	-	-	3
100	-	2	4
120	-	3	5
150	2	4	6
200	3	6	8
250	5	8	10

1A or 5A secondary

Option: Terminal cover

TAS23

Cable aperture 23mm dia
 Busbar window 30x10mm, 25x12mm, 20x11mm
 Secondary Terminals M4 screws/fast-on connectors
 Weight 250g

Supplied with fixing feet and busbar mounting bracket

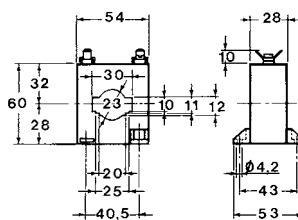
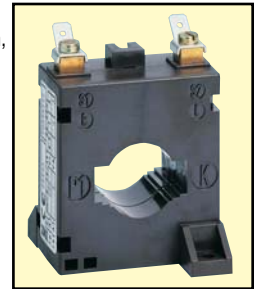

Primary current A	Burden		
	cl. 0-5 VA	cl. 1 VA	cl. 3 VA
150	-	-	1.5
200	-	2	3
250	-	2	3
300	2	3	4
400	3	4	5
500	4	5	6
600	5	6	8

1A or 5A secondary

Option: DIN rail adaptor
 Terminal cover

Moulded Case

TAS50, TAS63, TAS64, TAS65

TAS 50

Busbar window 51x12.5mm
 Secondary Terminals M4 screws/fast-on connectors
 Weight 430g

Supplied with fixing feet and busbar mounting bracket

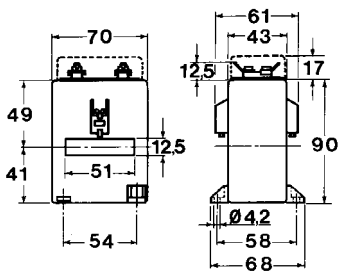

Option: Terminal cover

Primary current A	Burden		
	cl. 0-5 VA	cl. 1 VA	cl. 3 VA
250	-	-	3
300	-	2	4
400	-	4	6
500	2	4	6
600	6	8	10
800	8	10	12
1000	10	12	15
1200	12	15	20
double ratio with secondary selection			
250-500	-	-	3-6
600-1200	6-12	8-15	10-20
1A or 5A secondary			

TAS 64

Busbar window 64x11mm, 51x31mm
 Secondary Terminals M4 screws/fast-on connectors
 Weight 500g

Supplied with busbar mounting bracket

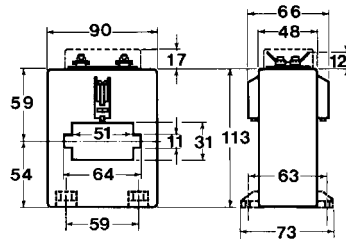

Option: Terminal cover
 Fixing feet

Primary current A	Burden		
	cl. 0-5 VA	cl. 1 VA	cl. 3 VA
250	-	2.5	4
300	-	3	5
400	-	4	6
500	2	4	6
600	4	6	8
700	6	8	10
750	6	8	10
800	6	8	10
1000	8	10	12
1200	10	12	15
1250	10	12	15
1500	10	12	15
1600	10	12	15
double ratio with secondary selection			
250-500	-	-	3-6
750-1500	6-10	8-12	10-15
1A or 5A secondary			

TAS 63

Busbar window 64x19mm, 51x20mm, 41x21mm
 Secondary Terminals M4 screws/fast-on connectors
 Weight 720g

Supplied with busbar mounting bracket

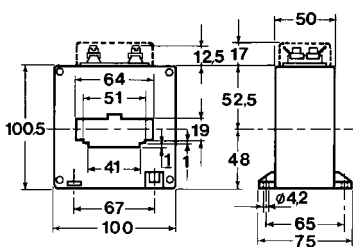
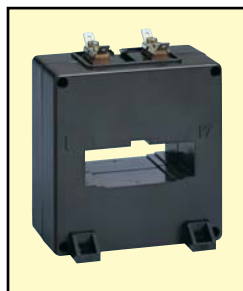

Option: Terminal cover
 Fixing feet

Primary current A	Burden		
	cl. 0-5 VA	cl. 1 VA	cl. 3 VA
150	-	1.5	5
200	-	3	8
250	2	5	-
300	3	6	-
400	6	12	-
500	6	12	-
600	10	20	-
800	12	25	-
1000	15	30	-
1200	20	40	-
1500	20	40	-
1600	20	40	-
double ratio with secondary selection			
150-300	-	1.5-6	-
750-1500	12-20	25-40	-
1A or 5A secondary			

TAS 65

Busbar window 65x32mm
 Secondary Terminals Pillar screw terminals
 Weight 750g

Supplied with busbar mounting bracket

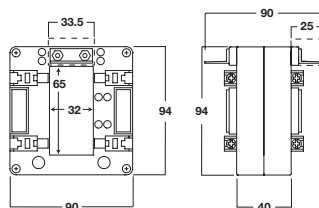
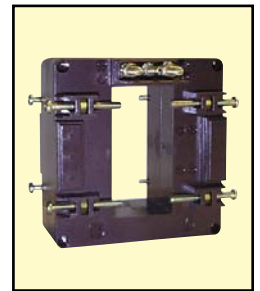

Option: Horizontal mounting (terminals on long side of CT - Ref TAS65H)

Primary current A	Burden		
	cl. 0-5 VA	cl. 1 VA	cl. 3 VA
200	-	2	5
250	1	4	6
300	1.5	6	7
400	4	8	10
500	8	10	12
600	8	12	15
700	10	12	15
750	10	15	15
800	12	15	20
1000	15	20	25
1200	15	20	25
1250	15	20	25
1500	20	25	30
1600	20	25	30
2000	20	25	30
1A or 5A secondary			

Moulded Case

TAS80, TAS81, TAS84, TAS105

TAS80

Busbar window 82x32mm
 Secondary Terminals M4 screws/fast-on connectors
 Weight 1500g

Supplied with busbar mounting bracket

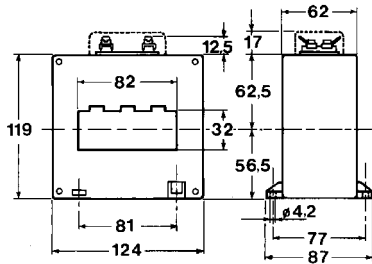

Option: Terminal cover
 Fixing feet

Primary current A	Burden	
	cl. 0-5 VA	cl. 1 VA
300	4	8
400	8	16
500	10	20
600	15	30
800	20	40
1000	20	40
1200	25	50
1500	40	80
1600	40	80
2000	50	100
2500	60	120
double ratio with secondary		
300-600	4-15	8-30
1250-2500	25-60	50-120
1A or 5A secondary		

TAS84

Busbar window 84x34mm
 Secondary Terminals M4 pillar
 Weight 700g

Supplied with busbar mounting bracket

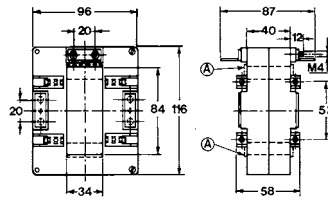

Option: Spacing device for 60mm bar
 Horizontal mounting (terminals on long side of CT - Ref TAS84H)

Primary current A	Burden		
	cl. 0-5 VA	cl. 1 VA	cl. 3 VA
150	-	-	2
200	-	-	4
250	-	-	5
300	-	2	6
400	3	5	8
500	5	7	10
600	6	10	12
700	6	10	12
750	8	12	15
800	8	12	15
1000	10	15	20
1200	12	15	20
1250	12	15	20
1500	15	20	25
1600	15	20	25
2000	20	25	30
2500	25	30	40
double ratio with secondary selection			
150-300	-	-	2-6
1250-2500	12-25	15-30	20-40
1A or 5A secondary			

TAS81

Busbar window 81x11mm, 64x31mm, 31x51mm
 Secondary Terminals M4 screws/fast-on connectors
 Weight 470g

Supplied with busbar mounting bracket

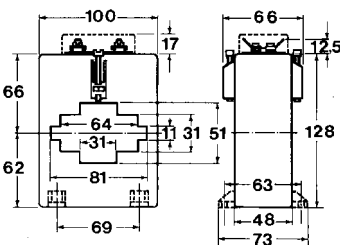
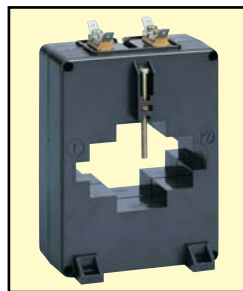

Option: Terminal cover
 Fixing feet

Primary current A	Burden		
	cl. 0-5 VA	cl. 1 VA	cl. 3 VA
400	-	2	3
500	2	4	6
600	3	5	8
800	4	6	8
1000	6	8	10
1200	8	10	12
1250	8	10	12
1500	10	12	15
1600	10	12	15
2000	10	12	15
2500	10	12	15
double ratio with secondary selection			
400-800	-	2-6	3-8
1250-2500	6-10	10-12	12-15
1A or 5A secondary			

TAS105

Busbar window 105x38mm
 Secondary Terminals Pillar Screw terminals
 Weight 900g

Supplied with busbar mounting bracket

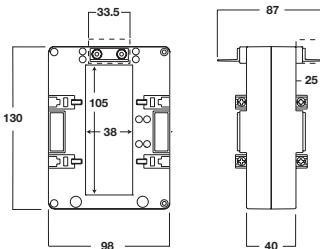

Option: Spacing device for 60mm bar
 Horizontal mounting (terminals on long side of CT - Ref TAS105H)

Primary current A	Burden		
	cl. 0-5 VA	cl. 1 VA	cl. 3 VA
200	-	1	4
250	-	2	5
300	-	3	7
400	1.5	5	8
500	3	8	10
600	5	9	12
700	8	10	12
750	8	10	15
800	8	12	15
1000	10	15	20
1200	12	15	25
1250	15	20	25
1500	15	20	25
1600	15	20	30
2000	20	30	40
2500	25	30	50
3000	25	30	50
4000	30	40	50
1A or 5A secondary			

Moulded Case

TAS125, TAS127, TAS127B

TAS125

Busbar window 127x54mm
 Secondary Terminals M4 screws/fast-on connectors
 Weight 2500g
 Supplied with busbar mounting bracket



TAS127B

Busbar window 127x54mm
 Secondary Terminals Pillar Screw terminal
 Weight 1300g
 Supplied with busbar mounting bracket

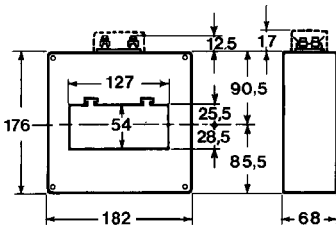

Option: Terminal cover

Primary current A	Burden	
	cl. 0-5 VA	cl. 1 VA
400	3	6
500	6	12
600	15	30
800	20	40
1000	20	40
1200	25	50
1500	40	80
1600	40	80
2000	50	100
2500	60	120
3000	60	120
4000	100	200

double ratio with secondary selection
 400-800 3-20 6-40
 2000-4000. 50-100 100-200
 1A or 5A secondary

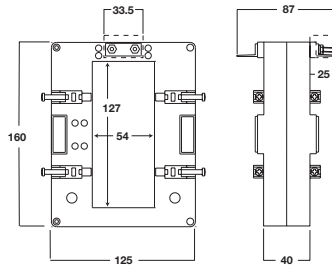

Option: Horizontal mounting (terminals on long side of CT - Ref TAS127BH)

Primary current A	Burden		
	cl. 0-5 VA	cl. 1 VA	cl. 3 VA
400	1	7	10
500	3	10	14
600	5	12	17
700	8	15	20
750	10	15	20
800	10	15	20
1000	12	20	25
1200	15	25	30
1250	15	25	30
1500	20	30	40
1600	20	30	40
2000	25	40	50
2500	30	50	60
3000	40	60	60
3200	40	60	60
4000	50	60	60
5000	60	60	60

1A or 5A secondary

TAS127

Busbar window 127x38mm
 Secondary Terminals M4 screws pillar
 Weight 1500g
 Supplied with busbar mounting bracket

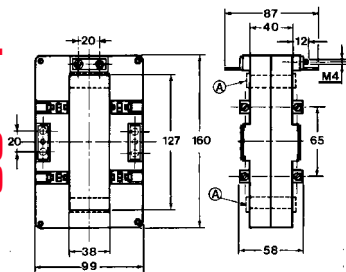

Option: Spacing device for 100mm bar

Option: Horizontal mounting (terminals on long side of CT - Ref TAS127H)

Primary current A	Burden		
	cl. 0-5 VA	cl. 1 VA	cl. 3 VA
400	-	3	6
500	2	4	8
600	4	6	10
700	4	8	10
750	4	8	10
800	4	8	10
1000	6	10	-
1200	8	12	-
1250	8	12	-
1500	10	15	-
1600	10	15	-
2000	15	20	-
2500	20	25	-
3000	25	30	-
3200	25	30	-
4000	30	40	-

double ratio with secondary selection
 400-800 - 3-8 6-10
 2000-4000 15-30 20-40 -
 1A or 5A secondary

3-PHASE CT'S

TA320

Ratios from 100/5A to 250/5A

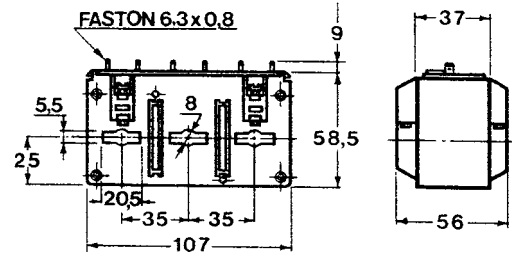

TA330

Ratios from 150/5A to 4000/5A

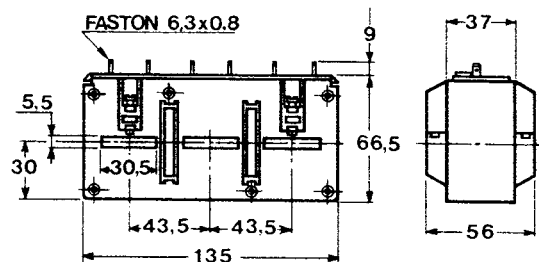

Information Required With Order

• Model • Ratio • Special requirements if applicable
 Example: Model TAS127 Current Transformer Ratio 2000/5A

Moulded Case Wound Primary

TAQ2, TAQ6, TAQ10, TAQ20

TAQ2

Primary connection M6 screws
 Secondary connection M4 screws/fast-on
 Weight 320g

Supplied with fixing feet

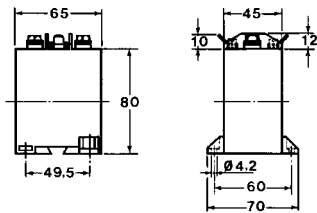

Primary current A	Burden		
	cl. 0-5 VA	cl. 1 VA	cl. 3 VA
1-1.5-2.5	2	4	6
5-7.5-10-15	2	4	6
20-25-30	2	4	6
40-50-60	2	4	6

1A or 5A secondary

Option: DIN rail adaptor
 Terminal boots or cover

TAQ6

Primary connection M6 screws
 Secondary connection M4 screws/fast-on
 Weight 350g

Supplied with fixing feet

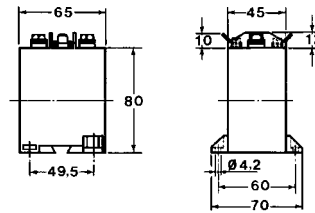
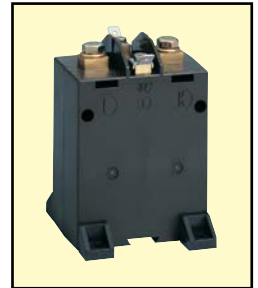

Primary current A	Burden	
	cl. 0-5 VA	cl. 1 VA
1-1.5-2.5	6	10
5-7.5-10-15	6	10
20-25-30	6	10
40-50-60	6	10

1A or 5A secondary

Option: DIN rail adaptor
 Terminal boots or cover

TAQ10

Secondary connection M4 screws/fast-on
 Weight 700g

Supplied with fixing feet

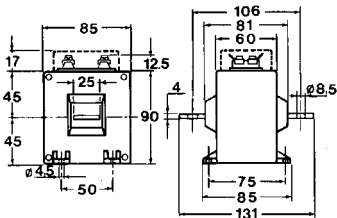

Primary current A	Burden	
	cl. 0-5 VA	cl. 1 VA
1-1.5-2.5	10	15
5-10-15	10	15
20-25-30	10	15
40-50-60	10	15
80-100-150	10	15
200-250-300	10	15

double ratio with secondary selection

5-10	-	4-12
20-40	-	4-12
30-60	-	4-12
50-100	-	4-12
125-250	-	4-12

1A or 5A secondary

Option: Terminal cover

TAQ20

Secondary connection M5 screws
 Weight 2000g

Supplied with fixing feet

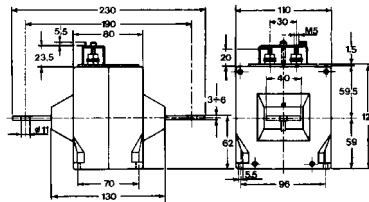

Primary current A	Burden	
	cl. 0-5 VA	cl. 1 VA
1-1.5-2.5	20	40
5-10-15	20	40
20-25-30	20	40
40-50-60	20	40
80-100-150	20	40
200-250-300	20	40
400-500-600	20	40

double ratio with secondary selection

5-10	6-20	12-40
20-40	6-20	12-40
30-60	6-20	12-40
50-100	6-20	12-40
125-250	6-20	12-40
300-600	6-20	12-40

1A or 5A secondary

Option: Terminal cover

Information Required With Order

• Model • Ratio • Special requirements if applicable
 Example: Model TAQ10 Current Transformer Ratio 80/5A